

Topla Top

ORDER INFORMATION

Short code	TT54
TAB ID	118654
DIN marking	55401 SMF
Quantity per EUR/CNT pallet	60/120 Pcs

TECHNICAL INFORMATION

Voltage	12 V
Capacity C20	54 Ah
CCA -18°C EN	510 A

DIMENSION AND WEIGHTS

Length/Width/Height	207x175x175 mm
Lead weight	7.1 kg
Electrolyte weight	3.9 kg
Total weight	12.3 kg

TECHNOLOGY

Type	Flooded
Grid type	Expanded
Grid alloy	Ca/Ca
Separator	PE
Electrolyte	1.28 g/cm ³

BOX DESIGNS

Container type	L1B
Colour	Black
Polarity	0
Base hold down	B13
Cover type	SMF
Layout	0
Terminal	1

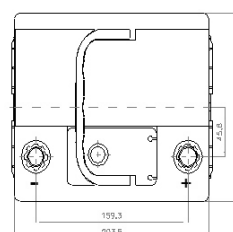
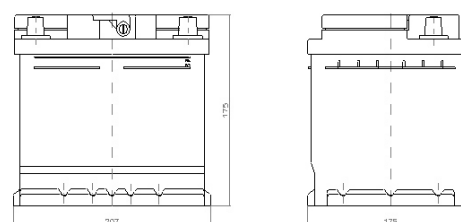

Base hold down



Layout

